



CITY COUNCIL AGENDA ITEM

REQUESTED COUNCIL MEETING DATE 7/17/07

SUBJECT: Neighborhood Investment Grant Program Award for FY 2006-07
[Treasure Isle Estates]

DEPARTMENT: CITY MANAGER'S OFFICE

RECOMMENDED MOTION:

To authorize the City award grant funds to the selected FY 2006-07 Neighborhood Investment Program applications.

SUMMARY:

Since 2000, the City's Neighborhood Investment Program (NIP) has provided eligible recipients with cash grants up to \$5,000.00 for projects that improve the quality of life in the City and specific neighborhoods.

Treasure Isle Estates was one of the neighborhoods the NIP Selection Committee reviewed and selected to receive funding. Treasure Isle requested assistance to install landscaping along their park entrance.

Staff recommends awarding **Treasure Isle Estates** a grant in the amount of **\$517.00**.

Funding is available for the NIP grant awards in account # 001-¹¹⁰⁰⁵⁷¹~~1000580~~-8300. If you have any questions, please contact Shannon McBride-Lewis, Assistant City Manager.

ATTACHMENTS: Ordinance Resolution Budget Resolution
 Other Supporting Documents and Contract

DEPARTMENT HEAD

Signed

Date 06.25.07

FINANCE DEPARTMENT

Approved as to Budget Requirements

Date 6/28/07

CITY ATTORNEY

Approved as to Form and Legality

Date

CITY MANAGER

Approved Agenda Item For:

7/17/07

COUNCIL ACTION: Approved as Recommended Disapproved
 Tabled Indefinitely Continued to Date Certain Approved with Modification

TREASURE ISLE MOBILE HOME PARK – PORT ORANGE

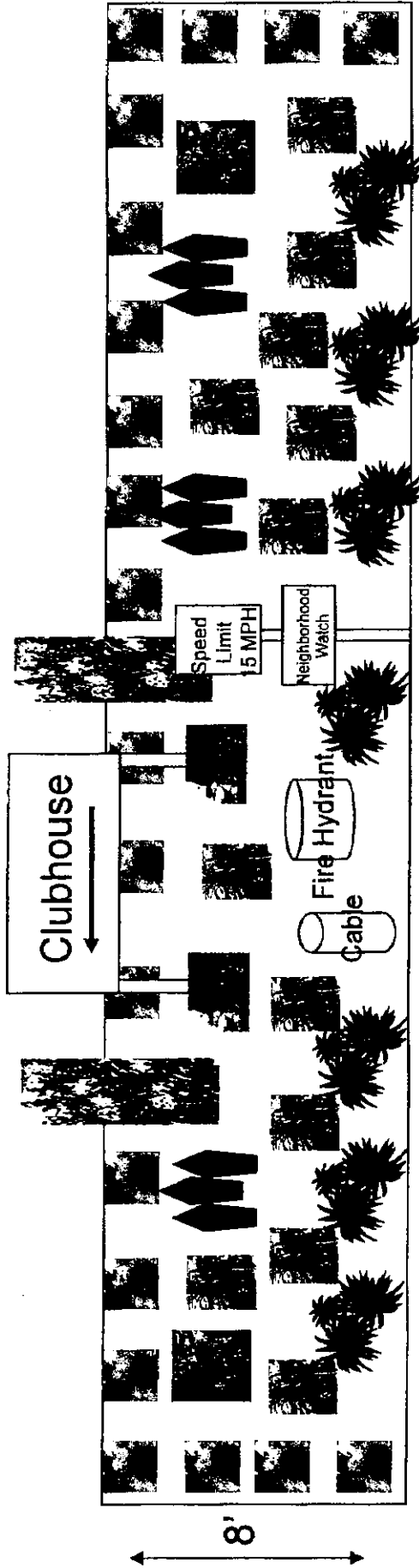

8'

48' (Not to scale)

(14) Crotons
Codiaeum
variegatum

(20) Muhly Grass

(2) Ixora

(2) Fire Bush

(2) Oleander
Nerium oleander

(7) Variegated Irirope

(9) Red Sister Ti Plant
Cordyline terminalis

**PORT ORANGE Neighborhood Investment Program
2006/2007 Application**

Neighborhood or Organization: Treasure Isle Esstates

Project Title: Treasure Isle Entrance Beautification

Project Leader: Mike Kliment

Mailing Address: 59 Windward Court

Port Orange, Florida 32127

Telephone: (Daytime) 386-767-8314

(Evening) same.

E-mail marebader@aol.com

(Fax)

Part One: Association

1. Neighborhood Association Boundaries (nearest streets):
(Please include a map showing the boundaries of the neighborhood)

Northern Boundary: Commonwealth Avenue

Southern Boundary: Nova Maplewood Estates

Eastern Boundary: US1

Western Boundary: Spruce Creek Road

2. When was the Association organized?

MAY 10th 1984 *Copy Attached*

3. How many members are in the Association:

125

Members are (check all that apply):

Homeowners

Renters

Business Owners

Other (specify)



Treasure Isle Homeowners' Association

112 Royal Palm Circle
Port Orange, FL 32127

A Not-for-Profit Association

June 7, 2007

Kent Donahue
City Manger's Office
City of Port Orange
1000 City Center Circle
Port Orange FL 32129

Mr. Donahue:

As a follow-up to our phone conversation last Thursday discussing the circumstances surrounding the grant applied for by our Homeowners' Association of Treasure Isle Estates, I would like to submit the following modification of the original approved grant for the beautification of our park's entrance.

We have modified our requirements since the new park owner chose to enhance part of the entrance per his specifications which did not conform to the original application. Therefore, we have modified our original plans to only apply to that portion of our entrance which has not been improved. Please see the attached drawings and photos representative of the proposed revision.

It is our hope that the revision we are submitting meets with your approval and that the grant will still be honored. We look forward to hearing from you with regard to the finalization of the grant.

Marilyn Bader

Marilyn Bader
President

Attachments: Photos & proposed layout
Cost Revisions

Concurrence:

P. Swick

~~D. Andrew Clark~~, Clark Properties, LLC

Patricia Swick, General Mgr.

6-8-07

Date

Board of Directors

Marilyn Bader, President
Donna Novak

Mike Kliment, Vice President
Bill Walker

Cheri Jenkins, Secretary
Dan Kliment Herm White

David Burnett, Treasurer
Ron Dugan

TREASURE ISLE MOBILE HOME PARK, PORT ORANGE

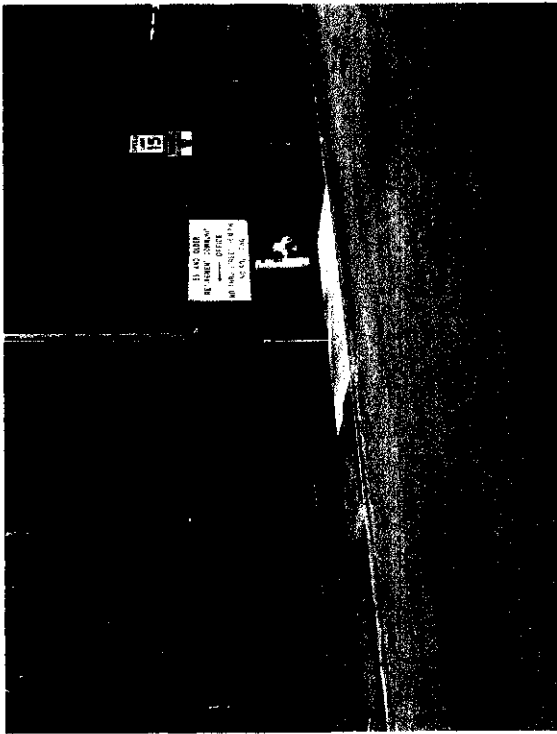
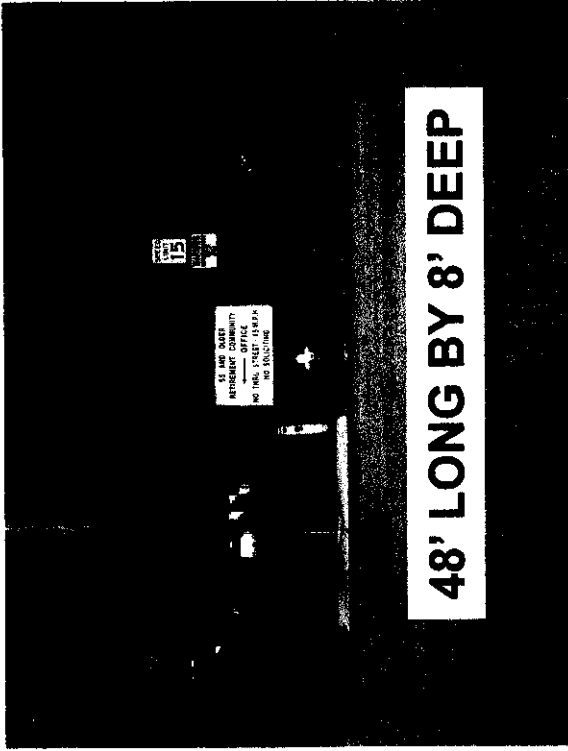

VIEW FROM SPRUCE CREEK AT PARK ENTRANCE

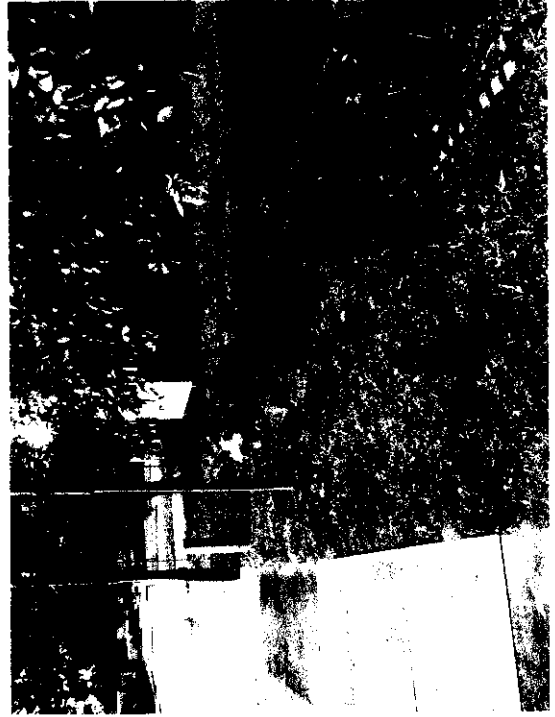

SAME LOCATION - DIRECTIONAL VIEW

4. Please list meetings, activities, and projects undertaken by the association in the past year.

Town Hall Meetings, Social Activities, Dinners Dances, Luncheons, Breakfast, Special committee meeting *See Attachment A*

5. Please attach to the application a copy of your homeowner association's Certificate of Good Standing issued by the Office of Secretary of State.

Part Two: Port Orange Neighborhood Investment

6. Briefly describe the proposed project (*Indicate whether this is a repair/replacement project due to the 2004 Hurricanes*):

Landscape Front Entrance to Park. Part of this project is due to hurricane damage

7. What is the location of the project?

Treasure Isle Estates
Front entry way off Spruce Creek Road

8. If the project is a physical improvement in the neighborhood (landscaping, entrance beautification, etc.), attach a scaled site plan and a drawing or rendering of the proposed project, which details the location, size, and measurements of the project. In addition, please attach photographs that include the project area(s).

Site Plan/Drawing/Photographs attached? Yes No N/A

ATTACHMENT A

Held Storm Ready Program for the residents of Treasure Isle provided by the FMO. Served lunch.

Prepared packets with hurricane information. Regarding location of motels, motels that would take pets. Information for the handicapped, and for those who would need special transportation. Location of the Hurricane shelters as well as television and radio stations to listen to for information
Emergency numbers.

Requested to have Treasure Isle considered for the state sponsored tie down and stabilizers program free for residents of mobile home parks. Applied and received grant money for this program. More than one hundred residents participated in this program. Completed the tie down program
October 30, 2006

State of Florida



Department of State

I certify that the attached is a true and correct copy of the Articles
of Incorporation of TREASURE ISLE MOBILE HOME PARK, INC.

a corporation organized under the Laws of the State of Florida,
filed on May 10, 1984.

The charter number for this corporation is H03039.

Given under my hand and the
Great Seal of the State of Florida,
at Tallahassee, the Capital, this the
15th day of June, 1984.



WP-104 CER-101

George Firestone
Secretary of State



FLORIDA DEPARTMENT OF STATE
Glenda E. Hood
Secretary of State

March 7, 2003

TREASURE ISLE MOBILE HOME PARI, INC.
101 FLAMINGO DR.
PORT ORANGE, FL 32127

SUBJECT: TREASURE ISLE MOBILE HOME PARK, INC.

DOCUMENT NUMBER: N98000004508

In compliance with the request on your 2003 Annual Report/Uniform Business Report, the certificate of status for the subject corporation is enclosed.

Should you have any questions regarding this matter, please telephone (850) 488-9000.

Division of Corporations

Letter No. 103A00014549

Reinstatement Section

State of Florida



Department of State

I certify from the records of this office that TREASURE ISLE MOBILE HOME PARK, INC. is a corporation organized under the laws of the State of Florida, filed on August 5, 1998.

The document number of this corporation is N98000004508.

I further certify that said corporation has paid all fees due this office through December 31, 2003, that its most recent annual report/uniform business report was filed on February 17, 2003, and its status is active.

I further certify that said corporation has not filed Articles of Dissolution.

Given under my hand and the
Great Seal of the State of Florida
at Tallahassee, the Capitol, this the
Seventh day of March, 2003



CR2EO22 (2-03)

Glenda E. Hood
Glenda E. Hood
Secretary of State

9. If a project is a physical improvement, is project on:

- Public right-of-way Private property
- Common area owned by organization

NOTE: Written permission from the appropriate government agency for the public right-of-way or the legal owner of the private property or common area will be required prior to beginning project.

10. If the project involves landscaping improvements, will drought tolerant plants and materials be utilized? Yes or No

If yes, then describe the quantities and the types.

- | | |
|--------------------------|--------------|
| a. Verigated Lirepoi #40 | d. Ixora #20 |
| b. Crotons #16 | e. |
| c. Red Sisters #16 | f. |

11. (A) Maintenance of the project once complete is important. **It is not the intent of the Port Orange Neighborhood Investment Program to increase maintenance obligations of the City.** The applicant is required to provide any additional maintenance made necessary to the project. Describe what type of maintenance, if any, will be required upon completion of the project (example: tree trimming, painting signs, repairs to equipment, service contract, etc.).

Trimming plants, weeding, to be done by park residents,

(B) Who will perform maintenance and how often (example: association members, residents adjacent to the project, a contractor hired by the association, etc.)?

Association Members and Park Employees
Monthly MAINTENANCE reported to COORDINATOR

Low Prices • Quality Products

COBTS

APPLICATION
[Revised July 2006]

Weedo's Landscape Supply

Stone • Gravel • Mulches • Sands • Soils & Much More!

We Deliver or You Pick Up Ask for MARY, KEITH, or TIM
1071 S. Nova Rd, Ormond Bch 32174 (386) 672-1837

X O O X O O
MURKIN
O O X O O X

- 1 - VER. HYBRIDIC
- RED SISTERS
- CPO TONS
- TUBS (ROSA)

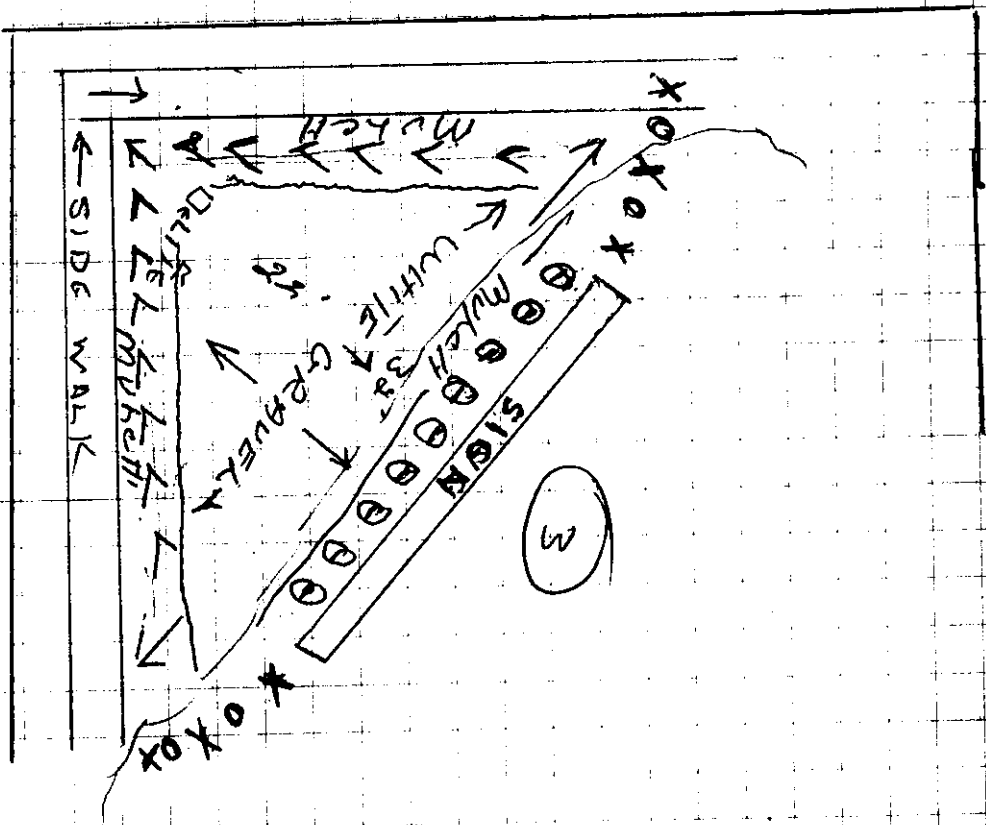
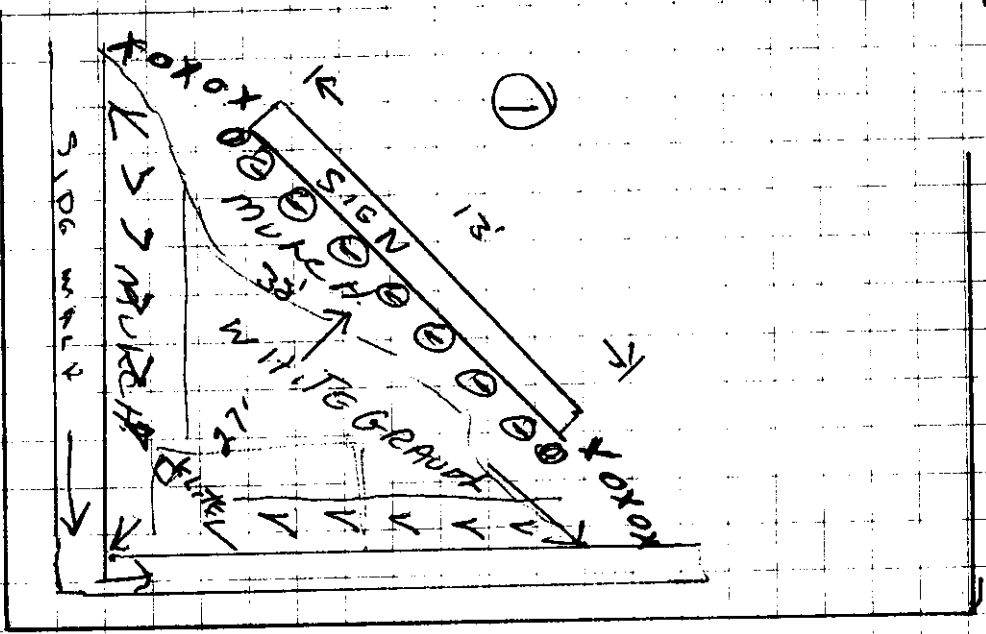

SEE ATTACHED SHEET

Part Three: Participation

12. How will neighborhood residents be involved in the project? Please be specific.

Labor and maintance
Monthly MAINTANCE WITH LABOR AS REQUIRED

13. List the name and address and obtain the signature of the owners of property immediately adjacent to a proposed physical improvement (example: for a proposed sign in the right-of-way next to a residence, the legal owner should be contacted about the project).

Owner's Name (Please print)	Address	Signature	Do you support this project – yes or no
N/A			

14. List five (5) association members who will serve as the association's project team.

Position	Name	Address	Telephone No.
Project Leader	Mike Kliment	59 Windward Court	767-8314
Partner/Volunteer Coordinator	DONNA NOUAK	7 Royal Palm	322 0285
Monthly/Quarterly Reports Coordinator	Marilyn Bader	8 Royal Palm Circle	788-3602
Disegin Coordinator	Dan Kliment	5 Royal Palm Circle	322-2028
Park Manager /Owner Representative	Chuck Healy	2 Royal Palm Circle	761-2511

15. Please complete the following items: PONIP project plan and time schedule; PONIP project computation sheet; Volunteer Hours Pledge Sheet (where applicable); Association Members Cash Pledge Sheet; Neighborhood Association Cash Pledge; and Partner's Letter of Intent.

I certify that the Neighborhood Association or Organization approved this PONIP application on (Date).

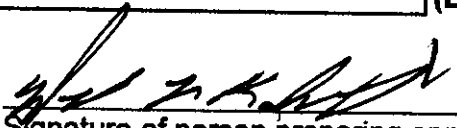
Signature of person preparing application

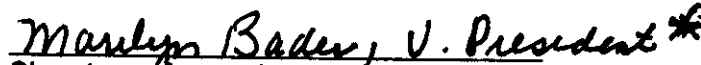
Signature of association president

Print name of person preparing application

Print name of association president

Date

Date

PRESIDENT HAS NOT RETURNED FROM HIS NORTHERN RESIDENCE.

**Project Plan and Time Line
Port Orange Neighborhood Investment Program**

Neighborhood Association: Treasure Isle Home Owners Association

Project Title: Treasure Isle Entrance Beautification

Description of Activity	Project Team Member Responsible	Expected Date of Completion**	Expenditures, In-Kind Contribution, and Volunteer Hours
Purchase , pickup and delivery of Materials	Mike Kliment	On or before Sept. 2007	

**** Note: All projects must be completed by September 30, 2007.**



Treasure Isle Homeowners' Association

142 Royal Palm Circle
Port Orange, FL 32127

A Not-for-Profit Association

June 7, 2007

Revised Cost Estimate
Grant to beautify entrance to park

[REVISED]

7	Variegated Liriope (1 gal)	2.50	17.50
2	Firebush	9.95	19.90
4	Ixora	9.00	36.00
2	Oleanders (4') Nerium oleander	40.00	80.00
20	Muhly Grass (1 gal. ea)	3.49	69.80
14	Croton Codiaeum variegatum	8.00	112.00
9	Red Sisters Ti Plant Cordyline terminalis	10.00	90.00
3 yds	Red Mulch (3" deep) delivered		76.00
1	Roll Black Mat (3'x300')	82.00	82.00
2 yds	Top soil (delivered)		50.06
	Sub Total		633.26
20 hrs	Labor	10.00	200.00
	TOTAL		833.26

Board of Directors

Marilyn Bader, President
Donna Novak

Mike Kliment, Vice President
Bill Walker

Cheri Jenkins, Secretary
Dan Kliment
Herm White

David Burnett, Treasurer
Ron Dugan

PROPOSED PONIP PROJECT COMPUTATION SHEET

(Multi-Year Projects: please use only numbers for current phase not the entire project.)

Neighborhood Association: Treasure Isle Mobile Home Park

Project Title: Neighborhood Investment Program

Your Organization's Cash Contribution:

From Neighborhood / Organization \$317.00

From Partner (s): \$

[REVISE D]

TOTAL CASH CONTRIBUTION:

317.00 (A)

Must be deposited with City of Port Orange Finance Department upon execution of PONIP grant agreement. **Make check payable to the City at the time the grant has been fully approved by the Port Orange City Council.**

Your Organization's In-Kind Contribution:

Volunteer labor 20 hours at \$10 per hour \$200.00

Professional Services hours at going rate \$

Materials/Supplies/Services
(Description and market value)

\$

\$

\$

TOTAL IN-KIND CONTRIBUTION

\$200.00 (B)

TOTAL MATCH (Cash + In-Kind)
(Must equal NIP Grant Request)

\$517.00 (C)
[Add A + B = C]

What is your NIP grant request in total dollars from the City: \$517.00 (D)
(Must equal to TOTAL MATCH above, up to a maximum of \$5,000 for a single year project)

**TOTAL PROJECT BUDGET
GRANT REQUEST AND ORGANIZATION'S CONTRIBUTION:**

\$1034.00 (E)
[Add C+D=E]

**Volunteer Hours Pledge Sheet
Port Orange Neighborhood Investment Program**

Neighborhood Association: TREASURE ISLE M/P

Project Title: TREASURE ISLE ENTRANCE BEAUTIFICATION

Name	Address/Zip	Phone Number	Hours Pledged	Task
MIKE KLIMENT	59 MIND ROAD	767-8314	30	PROJECT MNG LABOR
DAN KLIMENT	5 ROYAL PALM	322-2028 322-0285	30	PROJECT MNG LABOR
Danna MURAK	7-Royal palm		8	LABOR
MARILYN BADER	8 Royal Palm	788-3602	8	LABOR
Pat Taylor	64 Treasure		8	LABOR
MARY ILLIANT	5 ROYAL PALM 52 WINDWARD	322-2028 36	8	LABOR
MARILYN ILLIANT	57 WINDWARD	767-8314	8	LABOR
Faith Story	41 Royal Palm circle	871-6282	4	LABOR
Dee Follis	35 Royal Palm	788-9175	2	LABOR
PARK Hanging Hoop	PARK		40	
Art Cur	PACT 96 Flamingo		8	LABOR
Don Compton	93 Flamingo Dr	752-2355	8	LABOR

**Neighborhood Association Letter of Intent
Port Orange Neighborhood Investment Program**

11-3-06
Date _____

This letter is to confirm that _____
(Neighborhood Association)
pledges a contribution, after the grant is approved by the Port Orange City Council,
in the amount of \$ _____ as a cash match for a Port Orange Neighborhood
Investment Program Grant.

Neighborhood Association President: _____
Signature

Name (Please Print)

[Please Print]

Neighborhood Association: _____
Project Title: _____
Project Leader: _____
Mailing Address: _____

Telephone No.: (Day) _____ (Evening) _____
Fax No.: _____
E-mail: _____

**Partner Letter of Intent
Port Orange Neighborhood Investment Program**

Date 11/2/06

This letter is to confirm that KOHL FAMILY ASSOC. will
Company/Agency

participate as a partner with the TREASURE ISLES HOMEOWNERS
Neighborhood or Organizations' Name

In the implementation of its Port Orange Neighborhood Investment Program grant project. The contribution will consist of the following:

- Cash amount of \$ 400.00 (please make check payable to City of Port Orange)
- In-kind materials/supplies/services of:

40 HOURS LABOR @ \$10 = \$400.00

Signature: Walt Kohl Name: WALTER KOHL
Please print

Please print:

Company Agency: TREASURE ISLE ESTATES

Mailing address: 141 ROYAL PALM LIRIE

City/State/Zip: PORT ORANGE, FL. 32127

Telephone No.: 761-2511 Fax No.: 761-2574

E-mail: